

# Fire Box Assembly Instructions

## Assembly Tools Recommended

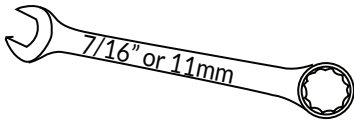

x 2

## Parts List



1/4" Nut & Bolt x 20

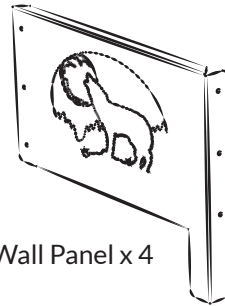

Side Wall Panel x 4

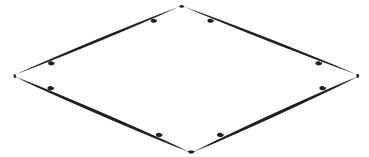

Base Panel x 1

## Assembly Instructions

1. Connect 3 wall panels together with bolts

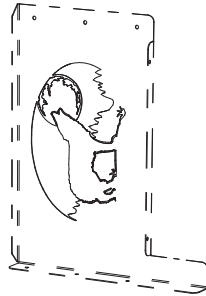

2. Insert base panel and secure

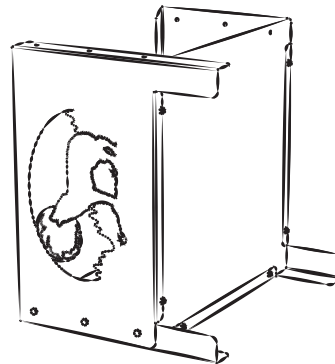
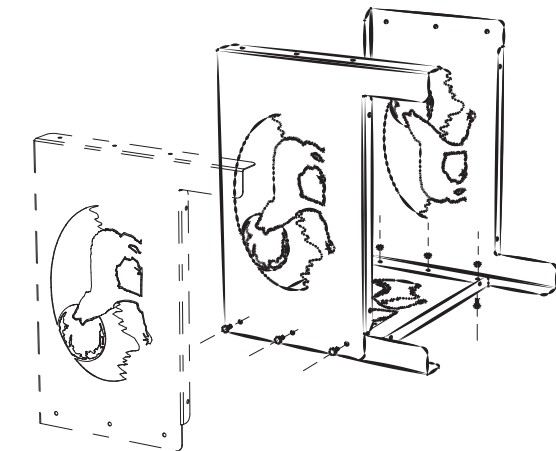

3. Secure final wall panel

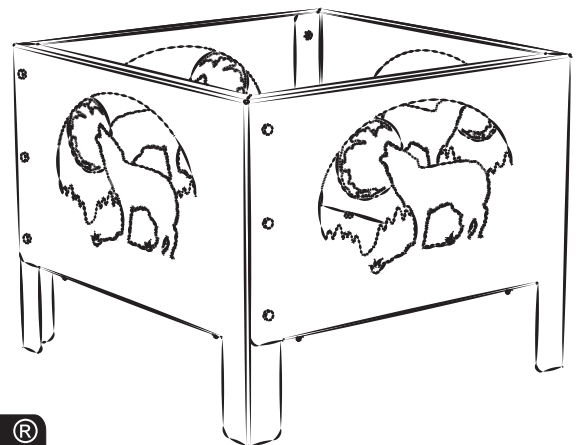
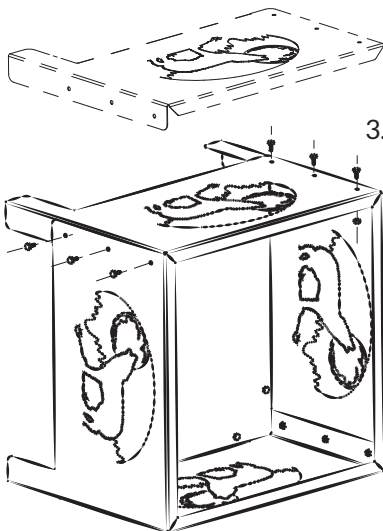

Made in Canada

**INFOCUS**<sup>®</sup>  
MANUFACTURING

Part Number: B5-0166

For more wonderful products, please visit -> [www.infocusmfg.com](http://www.infocusmfg.com)